



3/4 HP DELUXE



BIO SHIELD (Antimicrobial) for **ODOR PROTECTION!** Disposers are treated with an antimicrobial agent molded inside providing protection against odor causing bacteria growth.



THE TORQUE MASTER GRINDING SYSTEM is a combination of computer designed and balanced components working in unison to provide superior torque grind speed and long system life.

## MASTER EDITION

### Easy and Fast to Install

WASTEMAID disposers feature Speed Master Mounting, an exclusive system that provides fast and economical installation.

### Corrosion Proof

The WASTEMAID 458 carries a lifetime warranty against failure due to corrosion.

### Permanent Magnet Motors

WASTEMAID motors offer maximum torque instantly with the power to cut through potential jams.

### Compact and Lightweight

The compact design of your WASTEMAID allows inclusion where limited under counter space is available.

### Removable Splash Guard

All WASTEMAID models have a removable splash guard, ideal for easy cleaning and replacement.



The magnetic Silver Guard captures most metal objects before they enter into the disposer chamber. This protective feature helps prevent damage to valuable cutlery. It also helps prevent damage to the disposer as well as expensive repairs caused by metal objects falling into the disposer.

## SPECIFICATIONS

<b>HORSEPOWER</b>	3/4 HP
<b>MOTOR SPEED RPM</b>	2700 RPM
<b>VOLTAGE</b>	100v / 120v / 220-240v
<b>AMPS</b>	6.5 / 6.5 / 3.25
<b>CYCLES</b>	50/60
<b>MOTOR TYPE</b>	Permanent Magnet
<b>SPLASH GUARD</b>	PVC
<b>DRAIN OUTLET</b>	Polycarbonate 940
<b>GRIND RING</b>	Stainless Steel
<b>SWIVEL IMPELLERS</b>	Cast Stainless Steel
<b>BALANCED TURNTABLE</b>	Stainless Steel
<b>BALANCED ARMATURE SHAFT</b>	Stainless Steel
<b>HOPPER</b>	Polycarbonate 940
<b>DRAIN HOUSING</b>	Phenolic EA-5551J
<b>APPLIANCE PROTECTOR</b>	Manual Reset
<b>SINK FLANGE</b>	Polycarbonate 940
<b>STOPPER</b>	Stainless Steel, Knob Assembly
<b>BEARINGS</b>	Permanently Lubricated, Sleeve Type
<b>SOUND SHELL</b>	Full
<b>INDIVIDUAL SHIPPING WEIGHT</b>	5.9 KG
<b>MASTER CARTON WEIGHT (4 UNITS)</b>	25.4 KG
<b>MEASUREMENT A</b>	406 MM
<b>MEASUREMENT B</b>	184 MM
<b>MEASUREMENT C</b>	215 MM
<b>MEASUREMENT D</b>	142 MM White Elbow 147 MM Black Elbow
<b>MEASUREMENT E</b>	70 MM White Elbow 100 MM Black Elbow
<b>LIFETIME CORROSION GUARANTEE</b>	Yes

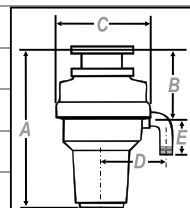

Anaheim Marketing International

4332 E. La Palma Ave. Anaheim CA 92807 USA Telephone (714) 993-1707 Fax (714) 993-1930  
email: ContactUs@AnaheimMarketing.com website: www.AnaheimMarketing.com